

# MEG Medical Enclosed Power Supply

## MEG-3K0A9T

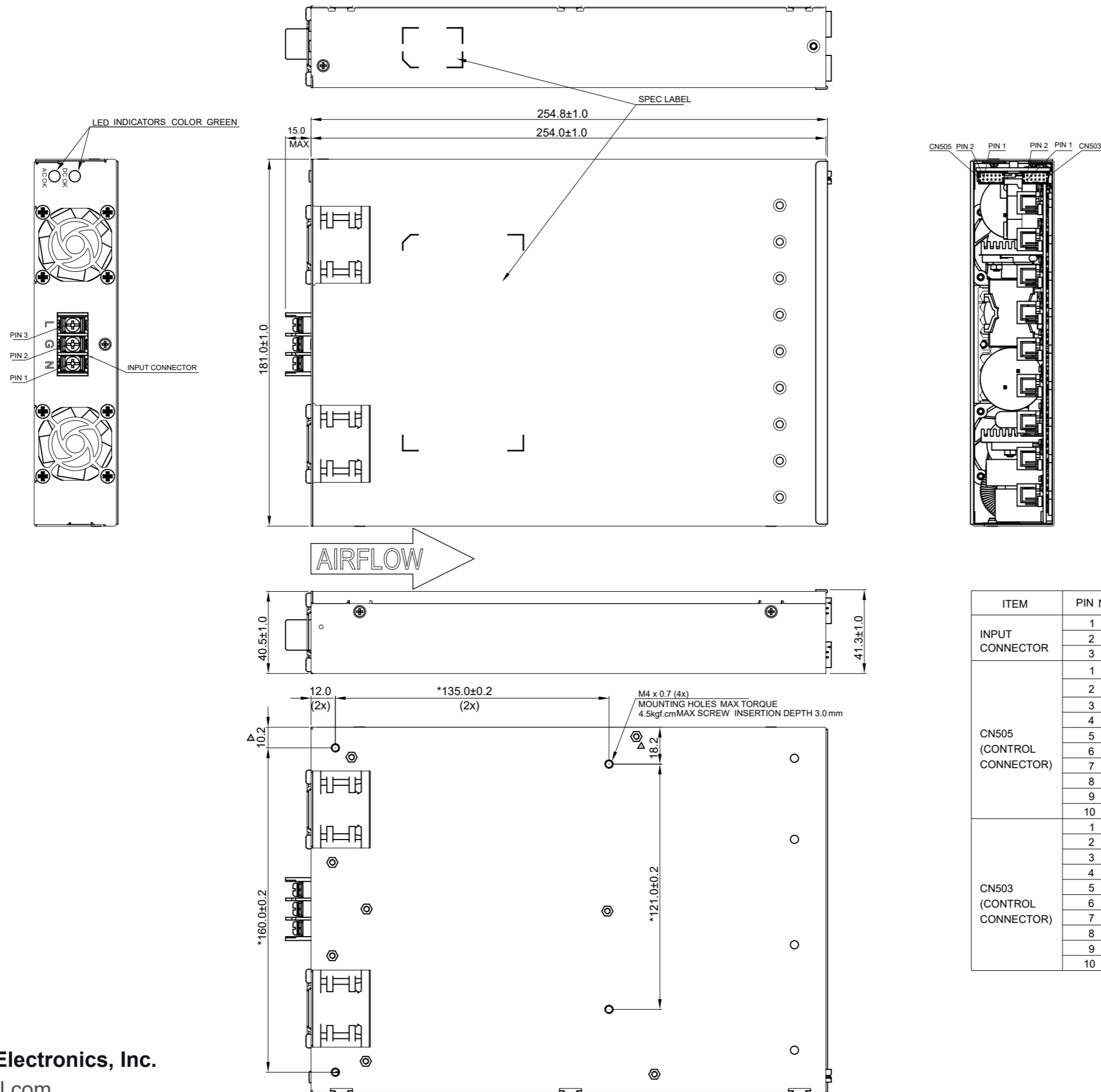

ITEM	PIN NO.	FUNCTION	REMARK
INPUT CONNECTOR	1	NEUTRAL	ANYTEK:YK50A (SCREW:M3.5 ZINC PLATED)
	2	GROUND	
	3	LINE	
CN505 (CONTROL CONNECTOR)	1	SMBALERT	MOLEX:87833-1031 MATING WITH MOLEX:51110-1051 TERMINAL:0503948052
	2	ADDRESS BIT 2 (A2)	
	3	ADDRESS BIT 1 (A1)	
	4	ADDRESS BIT 0 (A0)	
	5	RESERVE/NO CONNECTION	
	6	RESERVE/NO CONNECTION	
	7	PMBUS CLOCK(SCL)	
	8	PMBUS DATA(SDA)	
	9	5V COMMUNICATION BUS RETURN	
	10	5V COMMUNICATION BUS +	
CN503 (CONTROL CONNECTOR)	1	AC FAIL-"COLLECTOR"	MOLEX:87833-1031 MATING WITH MOLEX:51110-1051 TERMINAL:0503948052
	2	AC FAIL-"EMITTER"	
	3	5V STANDBY +	
	4	5V STANDBY +	
	5	5V STANDBY RETURN	
	6	5V STANDBY RETURN	
	7	GLOBAL REMOTE ON_OFF/INHIBIT +	
	8	GLOBAL REMOTE ON_OFF/INHIBIT -	
	9	RESERVE/NO CONNECTION	
	10	RESERVE/NO CONNECTION	

# MEG Medical Enclosed Power Supply

## MEG-3K0A9E

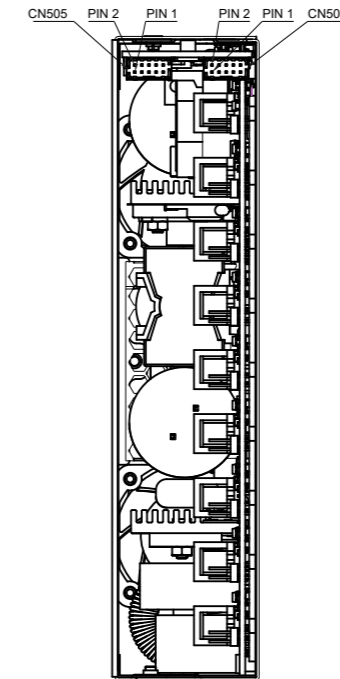
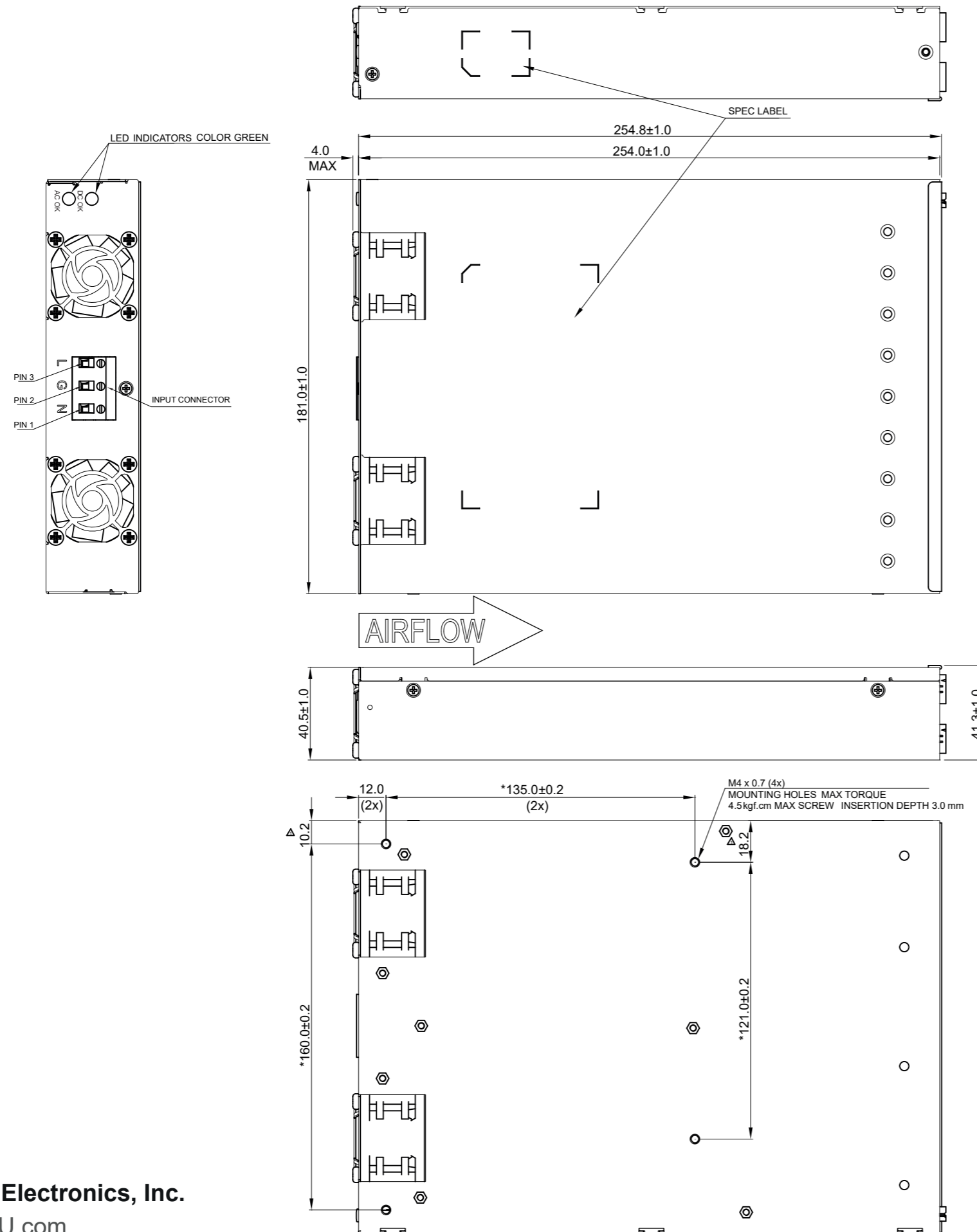

ITEM	PIN NO.	FUNCTION	REMARK
INPUT CONNECTOR	1	NEUTRAL	ANYTEK: TR031551000AG
	2	GROUND	
	3	LINE	
CN505 (CONTROL CONNECTOR)	1	SMBALERT	MOLEX: 87833-1031 MATING WITH MOLEX: 51110-1051 TERMINAL: 0503948052
	2	ADDRESS BIT 2 (A2)	
	3	ADDRESS BIT 1 (A1)	
	4	ADDRESS BIT 0 (A0)	
	5	RESERVE/NO CONNECTION	
	6	RESERVE/NO CONNECTION	
	7	PMBUS CLOCK(SCL)	
	8	PMBUS DATA(SDA)	
	9	5V COMMUNICATION BUS RETURN	
	10	5V COMMUNICATION BUS +	
CN503 (CONTROL CONNECTOR)	1	AC FAIL-"COLLECTOR"	MOLEX: 87833-1031 MATING WITH MOLEX: 51110-1051 TERMINAL: 0503948052
	2	AC FAIL-"EMITTER"	
	3	5V STANDBY +	
	4	5V STANDBY +	
	5	5V STANDBY RETURN	
	6	5V STANDBY RETURN	
	7	GLOBAL REMOTE ON_OFF/INHIBIT +	
	8	GLOBAL REMOTE ON_OFF/INHIBIT -	
	9	RESERVE/NO CONNECTION	
	10	RESERVE/NO CONNECTION	

# MEG Medical Enclosed Power Supply

## MEG-3K0A9C

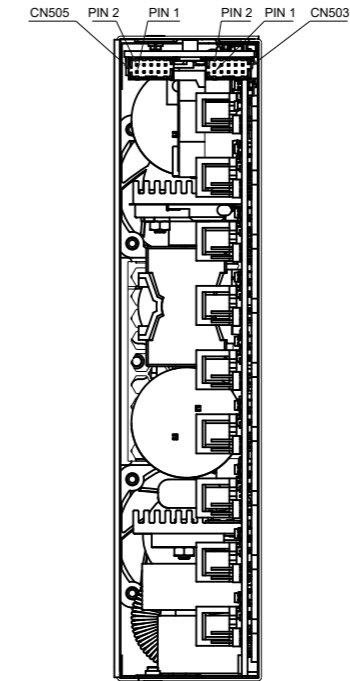
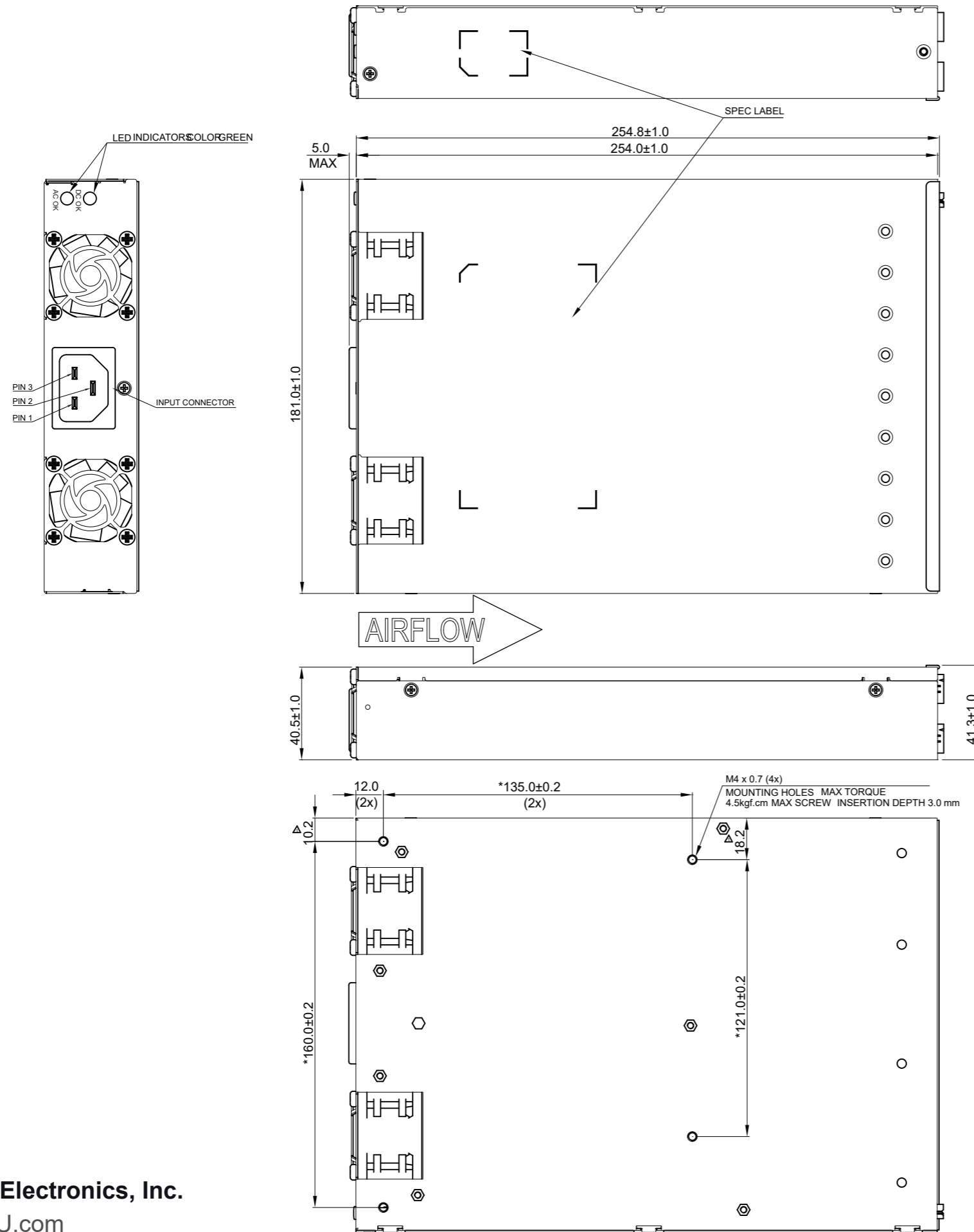

ITEM	PIN NO.	FUNCTION	REMARK
INPUT CONNECTOR	1	NEUTRAL	RONG FENG:SS-3BA-0.8-6.3A IEC320-C22
	2	GROUND	
	3	LINE	
CN505 (CONTROL CONNECTOR)	1	SMBALERT	MOLEX: 87833-1031 MATING WITH MOLEX: 51110-1051 TERMINAL: 0503948052
	2	ADDRESS BIT 2 (A2)	
	3	ADDRESS BIT 1 (A1)	
	4	ADDRESS BIT 0 (A0)	
	5	RESERVE/NO CONNECTION	
	6	RESERVE/NO CONNECTION	
	7	PMBUS CLOCK(SCL)	
	8	PMBUS DATA(SDA)	
	9	5V COMMUNICATION BUS RETURN	
	10	5V COMMUNICATION BUS +	
CN503 (CONTROL CONNECTOR)	1	AC FAIL-"COLLECTOR"	MOLEX: 87833-1031 MATING WITH MOLEX: 51110-1051 TERMINAL: 0503948052
	2	AC FAIL-"EMITTER"	
	3	5V STANDBY +	
	4	5V STANDBY +	
	5	5V STANDBY RETURN	
	6	5V STANDBY RETURN	
	7	GLOBAL REMOTE ON_OFF/INHIBIT +	
	8	GLOBAL REMOTE ON_OFF/INHIBIT -	
	9	RESERVE/NO CONNECTION	
	10	RESERVE/NO CONNECTION	